

## DEADLATCH LOCK

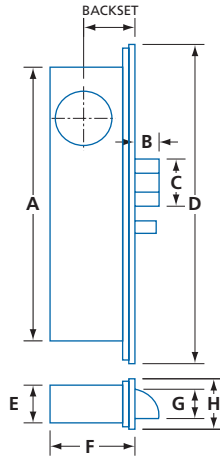

- Heavy zinc plated steel construction
- Chrome plated latch bolt with Delrin insert for smooth, quiet latching
- 1/2" (12.7 mm) latch throw
- Zinc alloy dead locking pin
- Left or right handed, field reversible
- Cylinder backset: 31/32" (24.6 mm) or 1 1/8" (28.6 mm)
- Lock accepts standard 1 5/32" (29.4 mm) diameter mortise cylinder with cam A (Adams Rite type)
- Key or turnbutton controlled latch dogging
- Radius anodized aluminum or duronodic faceplate included
- Other faceplates available, consult faceplate catalogue page (04.202)

MODEL NUMBER	HANDING	BACKSET	A	B	C	D	E	F	G	H	PER CASE	WEIGHT LBS / KG
DL2412	LH	31/32 (24.6)	5 27/32 (148.1)	1/2 (12.7)	1 (25.3)	6 7/8 (174.6)	7/8 (22.2)	1 19/32 (40.6)	5/8 (16.2)	1 (25.4)	25	28.6 / 13.0
DL2422	RH											
DL2413	LH	1 1/8 (28.6)						1 3/4 (44.2)				
DL2423	RH											

## HEAVY DUTY DEADLATCH LOCK

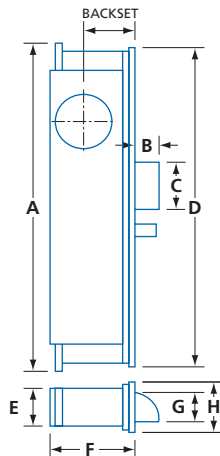

- Heavy zinc plated steel construction
- Adjustable mounting studs for easy lock alignment
- Solid zinc alloy latch bolt with 1/2" (12.7 mm) throw
- Zinc alloy dead locking pin
- Left or right handed, field reversible
- Cylinder backset: 31/32" (24.6 mm) or 1 1/8" (28.6 mm)
- Lock accepts standard 1 5/32" (29.4mm) diameter mortise cylinder with cam A (Adams Rite type)
- Key or turnbutton controlled latch dogging
- Radius anodized aluminum or duronodic faceplate included
- Other faceplates available, consult faceplate catalogue page (04.202)

MODEL NUMBER	HANDING	BACKSET	A	B	C	D	E	F	G	H	PER CASE	WEIGHT LBS / KG
DL2512	LH	31/32 (24.6)	7 (177.8)	1/2 (12.7)	1 (25.4)	6 7/8 (174.6)	7/8 (22.5)	1 5/8 (41.2)	5/8 (15.7)	1 (25.4)	25	28.6 / 13.0
DL2522	RH											
DL2513	LH	1 1/8 (28.6)						1 3/4 (43.7)				
DL2523	RH											

R2 02/11

Dimensions unless specified otherwise are: Inches (Millimeters)

## DEADBOLT LOCK

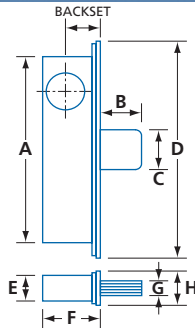
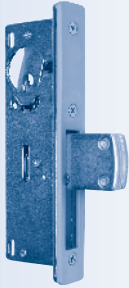

- Heavy zinc plated steel construction
- 5-ply laminated steel pivot bolt with 3 case-hardened center plies plus hardened roll pin (sawing test meets ANSI performance specifications)
- 1 3/8" (35.1 mm) bolt throw
- Non-handed
- Cylinder backset: 7/8" (22.2 mm), 31/32" (24.6 mm) or 1 1/8" (28.6 mm)
- Lock accepts standard 1 5/32" (29.4 mm) diameter mortise cylinder with cam A (Adams Rite type)
- Flat anodized aluminum or duronodic faceplate included
- Other faceplates available, consult faceplate catalogue page (04.202)

MODEL NUMBER	BACKSET	A	B	C	D	E	F	G	H	PER CASE	WEIGHT LBS / KG
DB2101	7/8 (22.2)	6 (152.7)	1 3/8 (35.1)	1 3/8 (34.4)	6 7/8 (174.6)	29/32 (22.8)	1 19/32 (40.0)	5/8 (15.3)	1 (25.4)	25	32.3 / 14.7
DB2102	31/32 (24.6)						1 5/8 (41.2)				
DB2103	1 1/8 (28.6)						1 25/32 (45.1)				

## SHORT THROW DEADBOLT LOCK

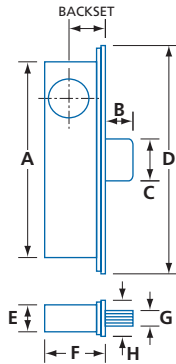

- Heavy zinc plated steel construction
- 5-ply laminated steel pivot bolt with 3 case-hardened center plies plus hardened roll pin (sawing test meets ANSI performance specifications)
- 13/16" (20.5 mm) bolt throw
- Non-handed
- Cylinder backset: 31/32" (24.6 mm) or 1 1/8" (28.6 mm)
- Lock accepts standard 1 5/32" (29.4 mm) diameter mortise cylinder with cam A (Adams Rite type)
- Flat anodized aluminum or duronodic faceplate included
- Other faceplates available, consult faceplate catalogue page (04.202)

MODEL NUMBER	BACKSET	A	B	C	D	E	F	G	H	PER CASE	WEIGHT LBS / KG
DB2202	31/32 (24.6)	6 (152.7)	13/16 (20.5)	1 11/32 (34.1)	6 7/8 (174.6)	29/32 (22.9)	1 5/8 (41.4)	5/8 (15.3)	1 (25.4)	25	30.1 / 13.7
DB2203	1 1/8 (28.6)						1 25/32 (45.1)				

## HOOKBOLT LOCK

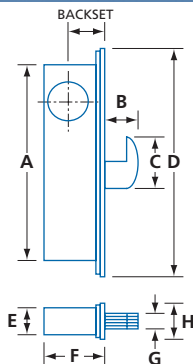

- Heavy zinc plated steel construction
- 5-ply laminated steel pivot bolt with 3 case-hardened center plies plus hardened roll pin (sawing test meets ANSI performance specifications)
- 13/16" (20.5 mm) bolt throw
- Non-handed
- Cylinder backset: 31/32" (24.6 mm) or 1 1/8" (28.6 mm)
- Lock accepts standard 1 5/32" (29.4 mm) diameter mortise cylinder with cam A (Adams Rite type)
- Flat anodized aluminum or duronodic faceplate included
- Other faceplates available, consult faceplate catalogue page (04.202)

MODEL NUMBER	BACKSET	A	B	C	D	E	F	G	H	PER CASE	WEIGHT LBS / KG
HB2302	31/32 (24.6)	6 (152.8)	17/32 (13.4)	1 1/4 (31.8)	6 7/8 (174.6)	29/32 (22.9)	1 5/8 (41.2)	5/8 (15.5)	1 (25.4)	25	28.6 / 13.0
HB2303	1 1/8 (28.6)						1 25/32 (45.1)				

Dimensions unless specified otherwise are: Inches (Millimeters)