

ACCESSORIES DL, DB & HB SERIES

SECURITY PRODUCTS

DL, DB & HB SERIES ACCESSORIES



- Strikes for DL series deadlatch
- LS01 standard flat stainless steel strike
- LS02 flat reversible stainless steel strike (used when converting to DL series from door prepped for DB or HB series)
- Includes black plastic dust box, steel mounting plate and machine screws

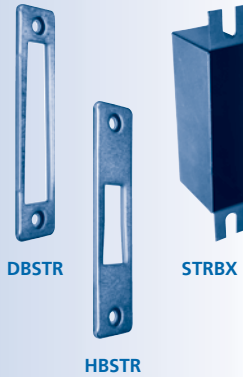

- DBSTR Heavy-duty zinc plated steel strike for DB series
- HBSTR Heavy-duty zinc plated steel strike for HB series
- STRBX steel dust box for DB or HB series strike

MODEL NUMBER	PER CASE	WEIGHT LBS / KG	MODEL NUMBER	PER BOX	WEIGHT LBS / KG
LS01	100	17.2 / 7.8	DBSTR	20	3.4 / 1.5
LS02		23.1 / 10.5	HBSTR		4.3 / 2.0
			STRBX		4.4 / 2.0



- Extension bolt provides 2-point locking when attached to DB or HB series
- Cylinder height up to 53 1/2" (1359 mm), 3/8" hardened steel hexagonal bolt with 11/16" (17.5 mm) bolt throw



- GB01 Heavy gauge steel guard box for DB or HB series provides added protection
- Accepts standard 1 1/8" (28.6mm) backset mortise deadbolt or hookbolt with 1 5/32" (29.4mm) diameter mortise cylinder
- LGF / RGF Heavy gauge steel faceplate provides added protection
- Used with guard box GB01

MODEL NUMBER	PER CASE	WEIGHT LBS / KG	MODEL NUMBER	HAND	PER CASE	WEIGHT LBS / KG
TPD2000K	50	39.6 / 18.0	GB01	N/A	10	22.9 / 10.4
			LGF	Left	80	27.4 / 12.4
			RGF	Right		

FACEPLATES

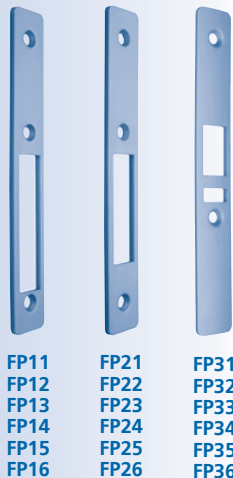

MODEL NUMBER	FITS SERIES	SIZE	FACEPLATE DESCRIPTION	SHAPE	ANODIZED FINISH	PER CASE	WEIGHT LBS / KG	STILE TYPE
FP11	DB	6 7/8" (174.6 mm) x 1" (25.4 mm)	Aluminum material, flat		AL, DU	25	1.4 / 0.6	
FP21	HB		Aluminum material, radius					
FP31	DL		Aluminum material, bevelled, LH					
FP12	DB		Aluminum material, bevelled, RH					
FP22	HB		Aluminum material, radius with weatherstrip, LH					
FP32	DL		Aluminum material, radius with weatherstrip, RH					
FP13	DB							
FP23	HB							
FP33	DL							
FP14	DB							
FP24	HB							
FP34	DL							
FP15	DB							
FP25	HB							
FP35	DL							
FP16	DB							
FP26	HB							
FP36	DL							

Dimensions unless specified otherwise are: Inches (Millimeters)

VIRO DEADLATCH LOCK

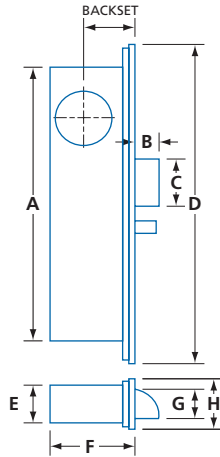
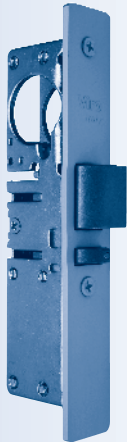

- Heavy galvanized steel construction
- Solid zinc alloy latch bolt
- Zinc alloy dead locking pin with ball bearing tip
- 17/32" (13.6 mm) latch throw
- Reversible
- Cylinder backset: 7/8" (22.2 mm), 31/32" (24.6 mm), 1 1/8" (28.6 mm) or 1 1/2" (38.1 mm)
- Lock accepts standard 1 5/32" (29.4 mm) diameter mortise cylinder with cam A (Adams Rite type)
- Key or turnbutton controlled latch dogging
- Faceplate sold separately, consult VIRO faceplate catalogue page (04.205)

MODEL NUMBER	BACKSET	A	B	C	D	E	F	G	H	PER BOX	WEIGHT LBS / KG
8516	7/8 (22.2)	5 13/16 (147.3)	17/32 (13.6)	1 (25.3)	6 7/8 (174.9)	7/8 (22.4)	1 1/2 (38.2)	5/8 (16.0)	1 (25.2)	1	0.8 / 0.4
8517	31/32 (24.6)						1 19/32 (40.6)				
8518	1 1/8 (28.6)						1 3/4 (44.6)				
8519	1 1/2 (38.1)						2 1/8 (54.1)				

VIRO DEADBOLT LOCK

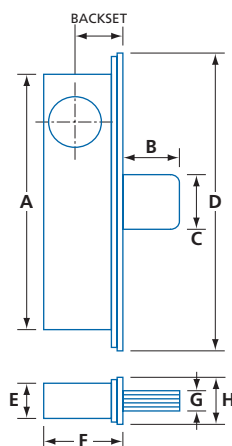
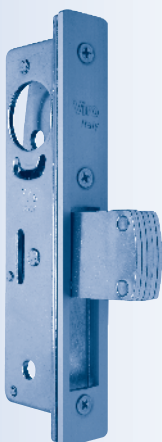

- Heavy galvanized steel construction
- Tough laminated swinging deadbolt
- 1 3/8" (34.9 mm) latch throw
- Non-handed
- Cylinder backset: 7/8" (22.2 mm), 31/32" (24.6 mm) or 1 1/8" (28.6 mm)
- Lock accepts standard 1 5/32" (29.4 mm) diameter mortise cylinder with cam A (Adams Rite type)
- Faceplate sold separately, consult VIRO faceplate catalogue page (04.205)

MODEL NUMBER	BACKSET	A	B	C	D	E	F	G	H	PER BOX	WEIGHT LBS / KG
8506	7/8 (22.2)	6 (152.5)	1 3/8 (34.9)	1 3/8 (34.3)	6 7/8 (174.9)	1 (25.2)	1 17/32 (38.9)	19/32 (15.0)	1 (25.2)	1	1.2 / 0.5
8507	31/32 (24.6)						1 5/8 (41.3)				
8508	1 1/8 (28.6)						1 23/32 (45.3)				

Dimensions unless specified otherwise are: Inches (Millimeters)