

05.024

DOOR HOLDERS

GENERAL HARDWARE

PLUNGER DOOR HOLDER

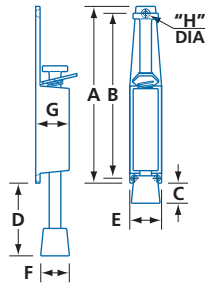

- Replacement rubber tip available: for #1014.02 use #1024.00 and for #1015.03 use #1015REP
- Finish: aluminum

MODEL NUMBER	MATERIAL	FINISH	A	B	C MIN	D MAX	E	F DIA	G	H DIA	PER BOX	WEIGHT LBS / KG
1014.02	Zinc die-cast	C28	4 3/4 (121)	4 1/4 (108)	13/16 (21)	2 1/8 (54)	1 (25.4)	13/16 (21)	15/16 (24)	11/64 (4.4)	6	1.6 / 0.6
1015.02			6 9/16 (167)	6 (152.5)	1 (25.4)	3 3/16 (81)	1 3/16 (30.1)	1 1/16 (27.7)	1 1/4 (31)	11/64 (4.4)		3.6 / 1.6

PLUNGER DOOR HOLDER

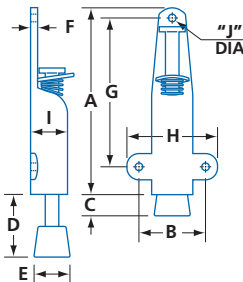

- Replacement rubber tip available #1024.00
- Finish: aluminum

MODEL NUMBER	MATERIAL	FINISH	A	B	C MIN	D MAX	E DIA	F	G	H	I DIA	J DIA	PER PIECE	WEIGHT LBS / KG
1024.02	Steel	C28	4 5/16 (110)	1 1/2 (38)	3/4 (19)	1 13/16 (46)	7/8 (22)	7/32 (7.1)	3 3/8 (86.5)	2 1/16 (53)	7/8 (22)	11/64 (4.4)	1	0.2 / 0.1

PLUNGER DOOR HOLDER

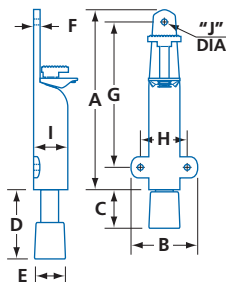

- Replacement rubber tip available #1026.00
- Finish: aluminum

MODEL NUMBER	MATERIAL	FINISH	A	B	C MIN	D MAX	E DIA	F	G	H	I	J DIA	PER PIECE	WEIGHT LBS / KG
1026.02	Steel	C28	6 13/16 (173)	1 1/2 (38)	1 1/2 (28)	2 11/16 (68)	1 1/8 (28)	7/32 (7.1)	5 1/2 (139.7)	1 3/4 (44.5)	1 1/4 (32)	7/32 (5.4)	1	6.6 / 3.0

R1 07/08

05.025

DOOR HOLDERS

GENERAL HARDWARE

DROP DOWN DOOR HOLDER

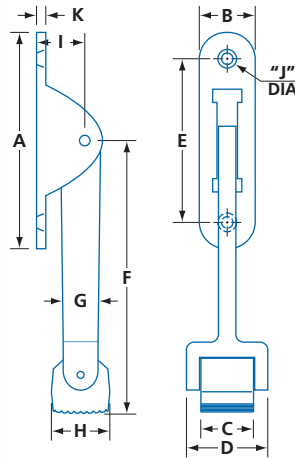

- Finish: aluminum

MODEL NUMBER	MATERIAL	FINISH	A	B	C	D	E	F	G	H	I	J DIA	K	PER BOX	WEIGHT LBS / KG
1060.02	Zinc die-cast	C28	4 5/16 (125)	1 (25.4)	1 (25.4)	1 1/2 (37.6)	2 15/16 (75)	5 (127)	5/8 (16)	1 1/16 (27)	7/8 (22.2)	7/32 (5.4)	5/32 (4)	8	2.8 / 1.3

DROP DOWN DOOR HOLDER

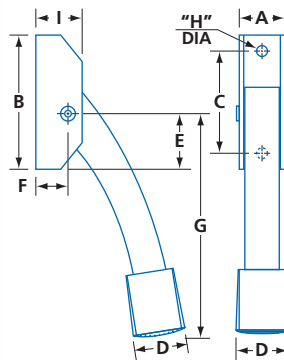

- Replacement tip available #1076.00
- Finish: aluminum

MODEL NUMBER	MATERIAL	FINISH	A	B	C	D SQ	E	F	G	H DIA	I	PER BOX	WEIGHT LBS / KG
1076.02	Steel	C28	13/16 (21)	2 3/8 (60)	1 13/16 (46)	15/16 (24)	15/16 (24)	5/8 (15)	4 1/4 (108)	13/64 (5)	13/16 (21)	10	3.4 / 1.5

R1 07/08