

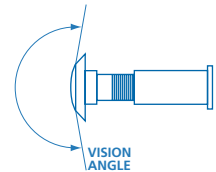

DOREX PRO DOOR VIEWER

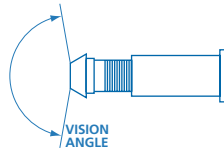

- Solid brass door viewer
- Polished optical glass lenses
- Rated: 20 minute fire resistance on wood door and 90 minute fire resistance on steel door
- Individually boxed
- Finish: polished brass or polished chrome

- Solid brass door viewer
- Polished optical glass lenses
- Rated: 20 minute fire resistance on wood door and 90 minute fire resistance on steel door
- Individually boxed
- Finish: polished brass or polished chrome

MODEL NUMBER	BORE	FIRE RATING	VISION ANGLE	FINISH	PER BOX	WEIGHT LBS / KG	MODEL NUMBER	BORE	FIRE RATING	VISION ANGLE	FINISH	PER BOX	WEIGHT LBS / KG
ML16	12 mm	20 / 90 min	160°	C3, C26	50	3.0 / 1.4	DS200	14 mm	20 / 90 min	200°	C3, C26	25	1.9 / 0.8

DOOR VIEWER

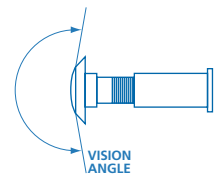
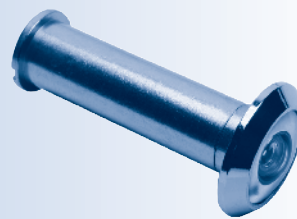
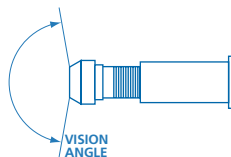
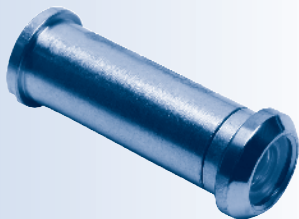

- Solid brass door viewer
- Acrylic optical lens
- DV160 series door viewer is intended for use with classified fire door rated up to and including 20 minutes
- Individually boxed
- Finish: bright brass, oil rubbed bronze or satin chrome

- Solid brass door viewer
- Acrylic optical lens
- DV180 and DV200 series door viewer with intended for use on classified fire door rated up to and including 20 minutes
- Individually boxed
- Finish: bright brass, oil rubbed bronze or satin chrome

MODEL NUMBER	BORE	FIRE RATING	VISION ANGLE	FINISH	PER BOX	WEIGHT LBS / KG	MODEL NUMBER	BORE	FIRE RATING	VISION ANGLE	FINISH	PER BOX	WEIGHT LBS / KG
B02	12 mm	N/A	160°	C3, C10B, C26D	50	3.0 / 1.4	B03	14 mm	N/A	180°	C3, C10B, C26D	12	0.8 / 0.35
DV160		20 min		3, 26D			DV180		20 min		3, 26D		
							B04	16 mm	N/A	200°	C3, C26D		1.0 / 0.46
							DV200	14 mm	20 min		3, 26D		

R2 02/11

Dimensions unless specified otherwise are: Inches (Millimeters)

PEEK® DOOR VIEWER

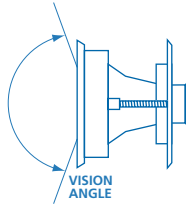
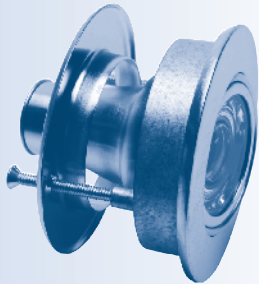

- Revolving door viewer
- Stamped brass components
- Crystal optical glass lenses
- For 1" (25.4 mm) to 2" (50.8 mm) door thickness
- Individually boxed
- Finish: polished brass, satin bronze or satin chrome

MODEL NUMBER	BORE	FIRE RATING	VISION	FINISH	PER BOX	WEIGHT LBS / KG
511	2 3/8 (60.3)	N/A	140°	C3, C10, C26D	1	0.4 / 0.2

Door Scope® DOOR VIEWER Warnock Hersey

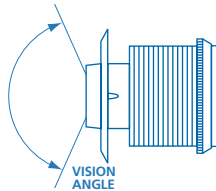

- Reflex door viewer with 2" (50.3 mm) screen
- Precision optics, no image distortion
- DS1000 Warnock Hersey listed for 60 minutes fire rated location when used with proprietary firestop sealant (not supplied) on a wood composite fire door
- DS2000 Warnock Hersey listed for 20 minutes fire rated location when used with proprietary firestop sealant (not supplied) on a wood composite fire door
- Individually carded
- Finish: DS1000 - black, brass or grey and DS2000 - silver

MODEL NUMBER	BORE	MATERIAL	FIRE RATING	VISION	FINISH	PER BOX	WEIGHT LBS / KG
DS1000	2 3/8 (60.3)	ABS plastic	60 min	132°	BL, BR, GR	1	0.6 / 0.3
DS2000		Aluminum	20 min		SL		

DOOR VIEWER c UL US

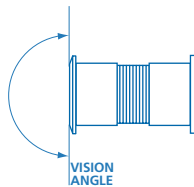
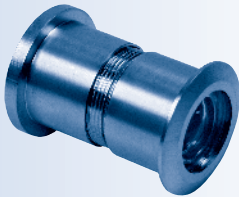

- Solid brass door viewer
- Acrylic optical lens
- Viewer is intended for use with classified fire door rated up to and including 20 minutes
- Individually boxed
- Finish: polished chrome

MODEL NUMBER	BORE	FIRE RATING	VISION	FINISH	PER BOX	WEIGHT LBS / KG
DV180D	26 mm	20 min	180°	26D	12	1.8 / 0.83

Dimensions unless specified otherwise are: Inches (Millimeters)